

Use Permit #15-00013

950 Big Bethel Road
By Benita Taylor



City Council
January 13, 2015

HAMPTON VA

USE PERMIT APPLICATION

- Use permit for the operation of a Day Care 3

AREA LOCATION

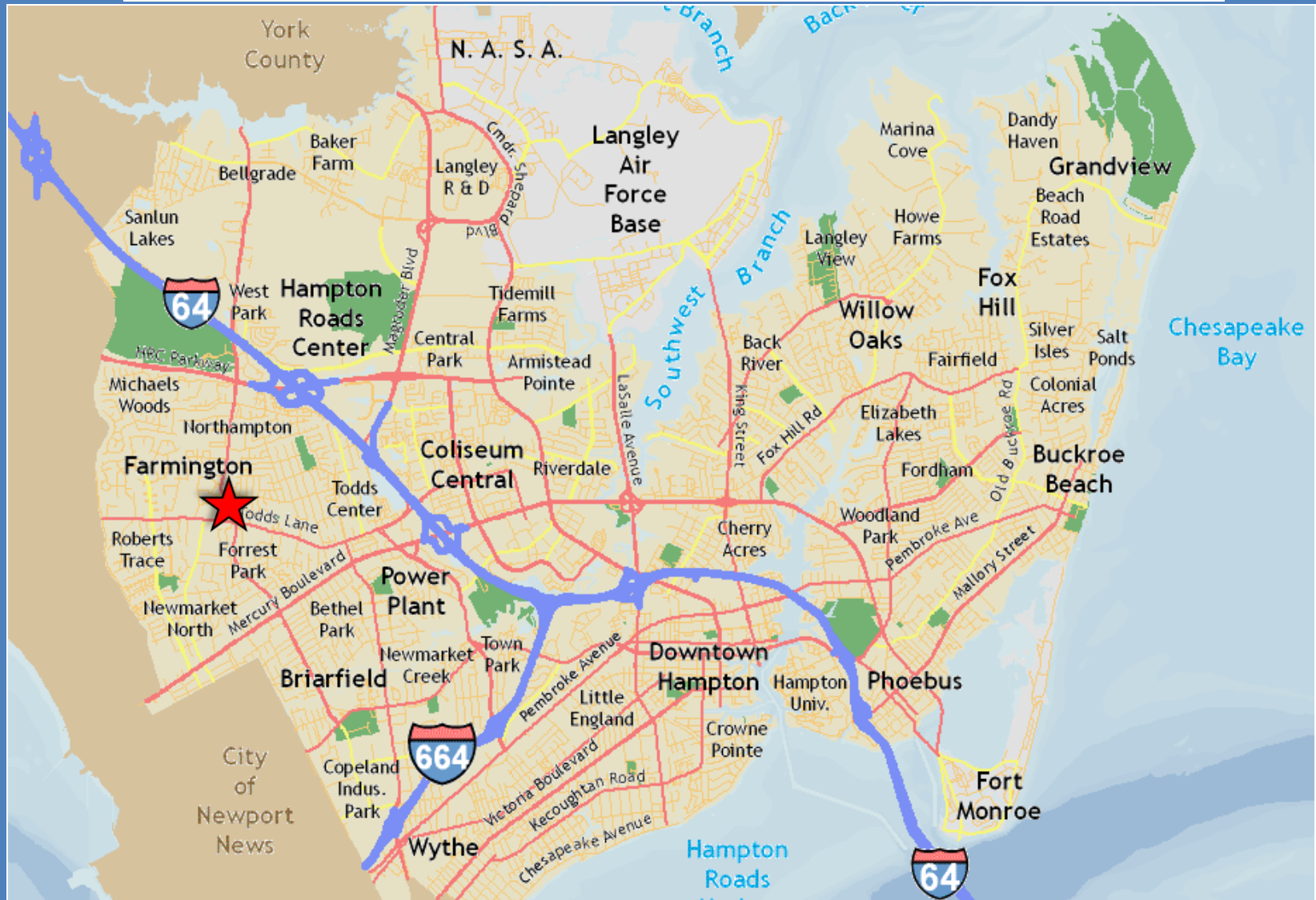

SITE LOCATION



CURRENT ZONING

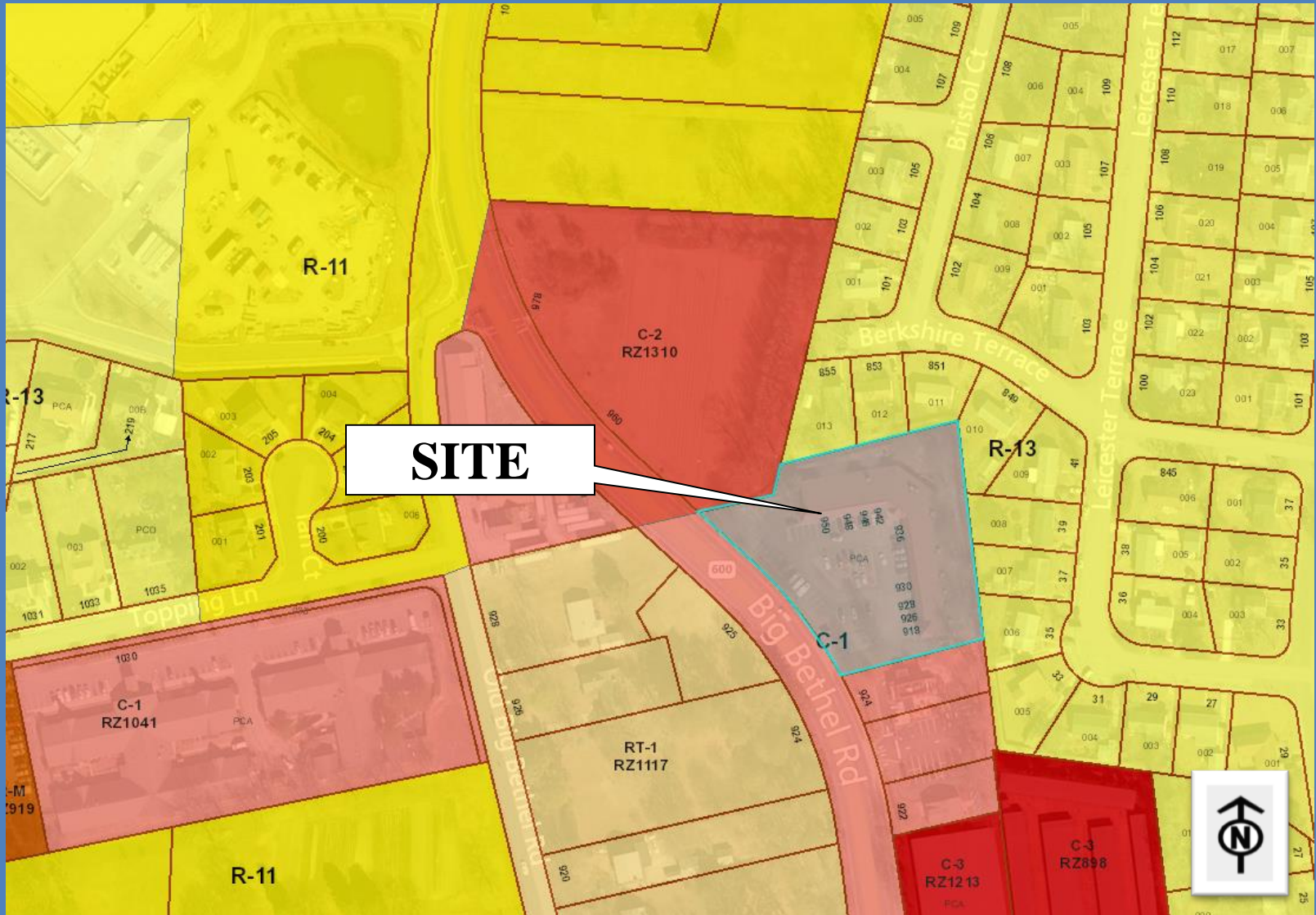

FUTURE LAND USE

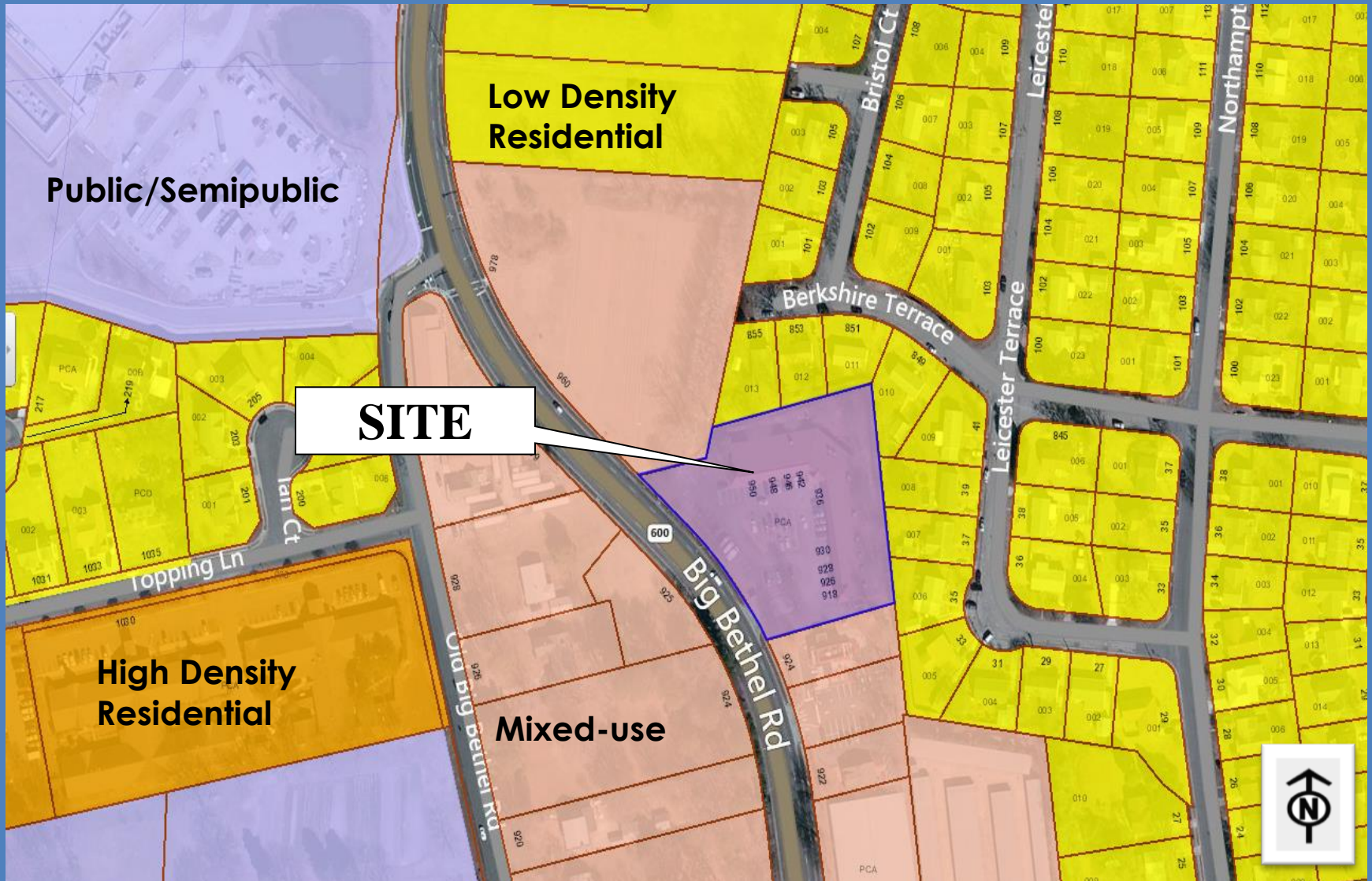

CONDITIONS

- **Location & hours of operation**
- **Capacity**
- **Age of clients**
- **Revocation**

CONDITIONS

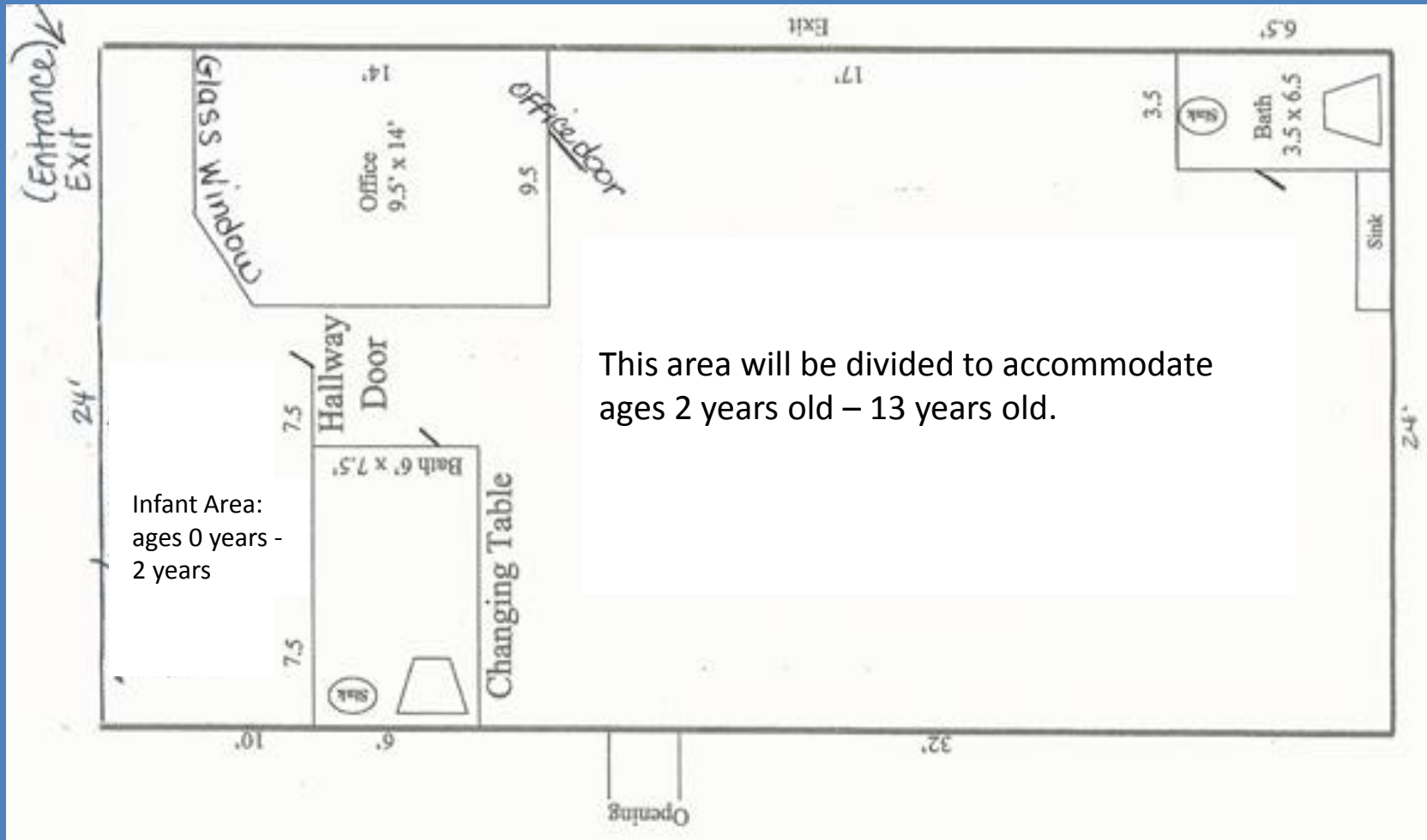

Infant Area:
ages 0 years -
2 years

PUBLIC POLICY

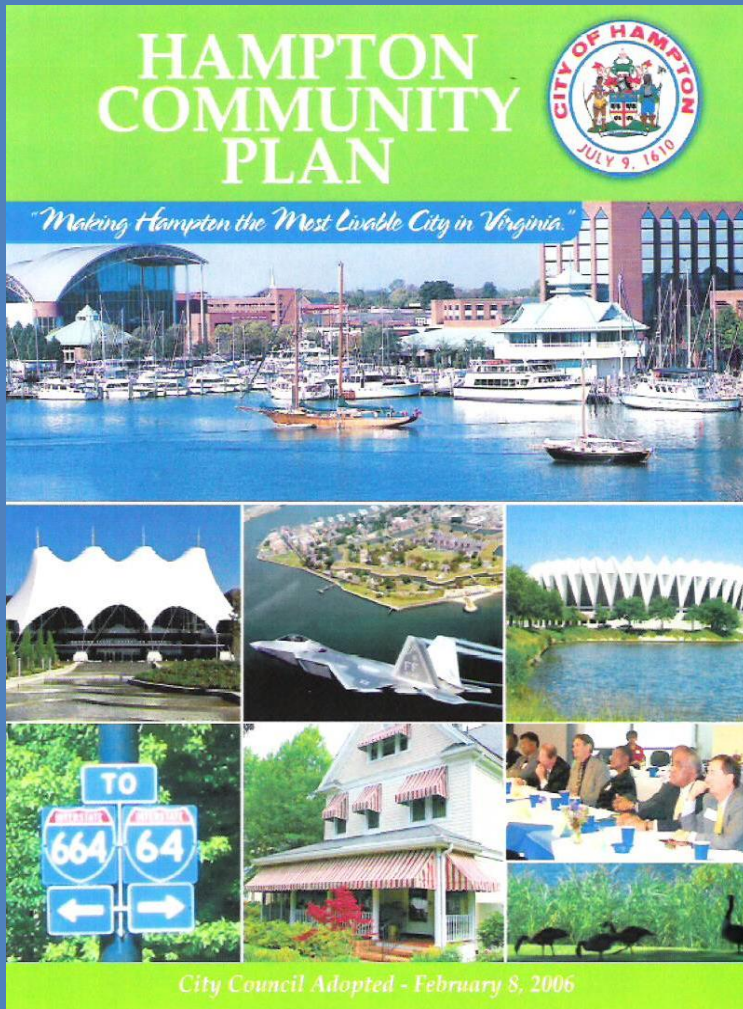

City Council Adopted - February 8, 2006

(2006, as amended)

- Promotes nurturing youth environment
- Promotes quality community facilities

COMMUNITY MEETING

NOVEMBER 2015

Monday	Tuesday	Wednesday	Thursday	Friday	Saturday	Sunday
26	27	28	29	30	31	1
2	3	4	5	6	7	8
9	10	11	12	13	14	15
16	17	18	19	20	21	22
23	24	25	26	27	28	29
30 	1	2	3	4	5	6

RECOMMENDATION

**STAFF & PLANNING COMMISSION
RECOMMENDS APPROVAL OF
USE PERMIT APPLICATION 15-00013
WITH 10 CONDITIONS**