



Sentara PK-8 School

Presentation to the
Hampton City Council
June 20, 2007

Use Permit Conditions

- Substantial conformance with site plan submitted
- Architectural elements to reflect Greater Wythe Neighborhood
- Preserve trees to greatest extent possible.
- Design Community Use spaces and site to facilitate public access
- The Assembly portions (rear) of building will be designed as primary emergency shelter
- Bus Parking lot will be utilized as car parking when not in use
- Site lighting will not spill onto neighbors
- Utilize Crime Prevention through Environmental Des. (CPTED)
- Use collaborative approach to design park and field areas
- The building will be constructed and designed to meet High Performance standards. (LEED or similiar)

Designed as Primary Emergency Shelter

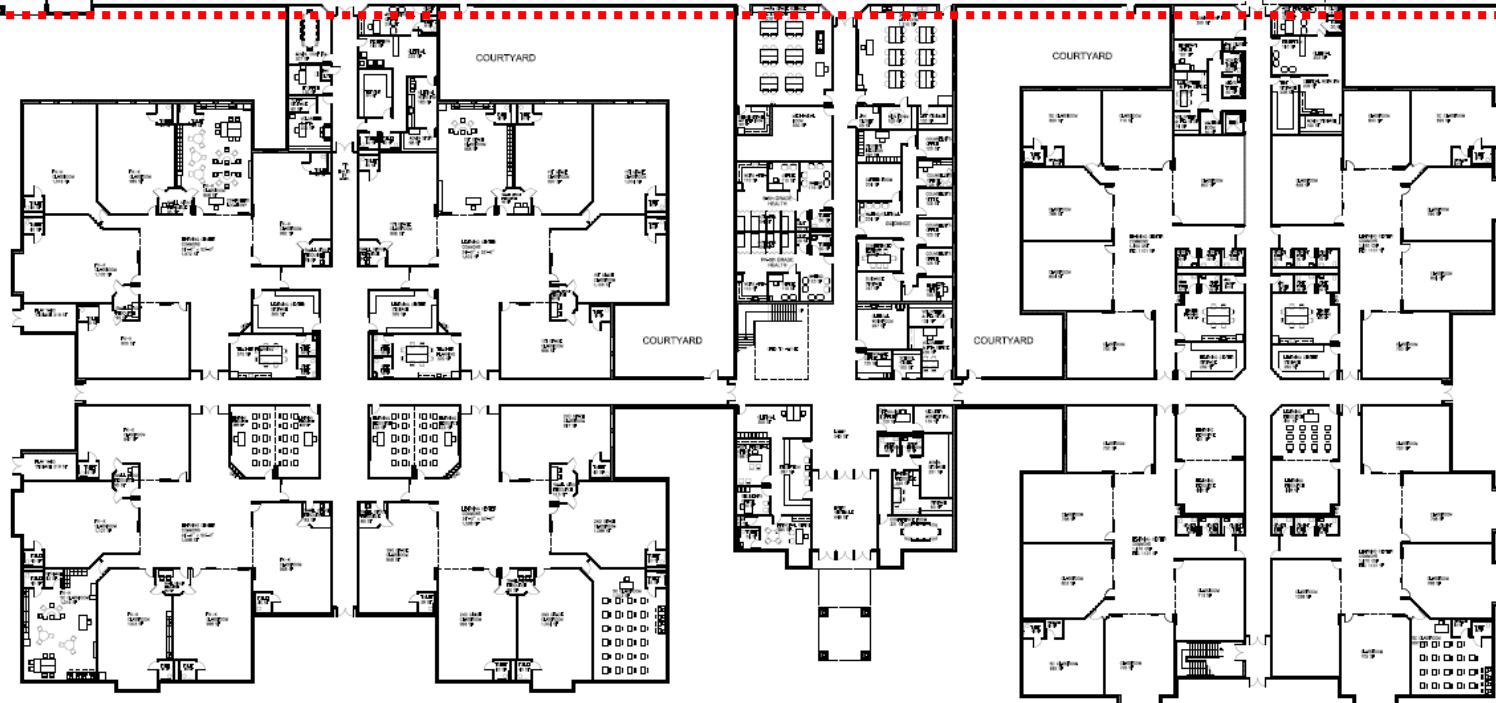
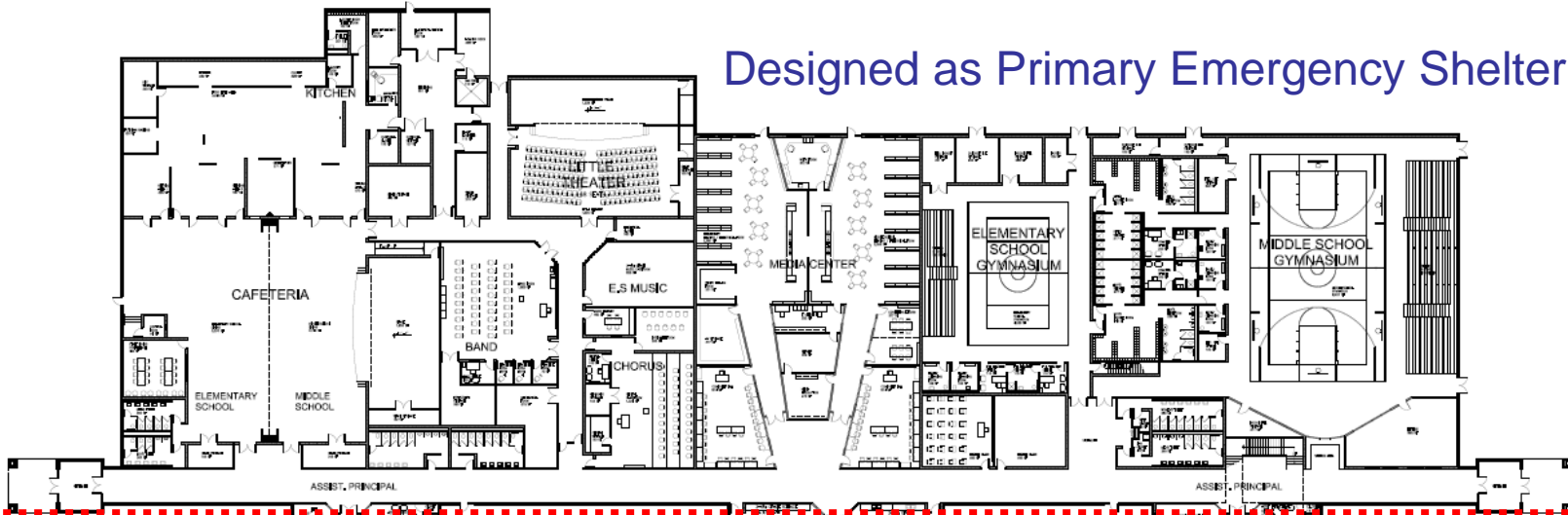

EARLY EDUCATION
PR - K THRU 2nd GRADE
FIRST FLOOR PLAN

OVERALL FIRST FLOOR PLAN
MAY 22, 2007

3rd THRU 5th GRADE
FIRST FLOOR PLAN

PROGRESS PRINT NOT FOR CONSTRUCTION

MOSELEY ARCHITECTS
A PROFESSIONAL CORPORATION

1000 W. 10TH AVENUE, SUITE 1000, DENVER, CO 80202
TEL: 303.733.1111 FAX: 303.733.1112
WWW.MOSELEYARCHITECTS.COM

PK - 8 GRADE SCHOOL
3116 & 3120 VICTORIA BOULEVARD
HAMPTON CITY SCHOOLS
HAMPTON, VIRGINIA

DATE: 10-04-05	BY: [Signature]
REVISION	BY: [Signature]
REVISION	BY: [Signature]
REVISION	BY: [Signature]

FIRST FLOOR
OVERALL PLAN

A2.0



MOSELEYARCHITECTS
A PROFESSIONAL CORPORATION

750 LYNHAVEN PARKWAY, SUITE 200 VIRGINIA BEACH, VIRGINIA 23452
PHONE (757) 38-2800 FAX (757) 368-2233

PK - 8 ELEMENTARY/MIDDLE SCHOOL
VICTORIA BOULEVARD - SENTARA SITE
HAMPTON CITY SCHOOLS
HAMPTON, VIRGINIA



PROJECT NO: 461490

F

1

1

1



NORTH ELEVATION: NTS



EAST ELEVATION: NTS



SOUTH ELEVATION: NTS



WEST ELEVATION: NTS

MOSELEYARCHITECTS
A PROFESSIONAL CORPORATION

3811 VANDERBILT PARKWAY, SUITE 200, VIRGINIA BEACH, VIRGINIA 23462
PHONE (757) 546-8800 FAX (757) 546-2228
MOSELEYARCHITECTS.COM

PK - 8 ELEMENTARY/MIDDLE SCHOOL
VICTORIA BOULEVARD - SENTARA SITE
HAMPTON CITY SCHOOLS
HAMPTON, VIRGINIA

PROJECT NO. 0410
SHEET NO.
DATE
DESIGNED BY
CHECKED BY
APPROVED BY

A1

PROGRESS PRINT NOT FOR CONSTRUCTION

