

City of Hampton, VA
FY 2018 VDOT Road Submittal
(Deletions)

Prepared by: Dept. of Public Works -Engineering Services

Scale: 1" = 500'



Map printed: 14 November, 2016

1.24 Centerline Miles
3.94 Lane Miles
(Additions)

REQUEST FOR STREET ADDITIONS OR
DELETIONS FOR MUNICIPAL ASSISTANCE
PAYMENTS Section 33.1-4 1.1
Code of Virginia

MUNICIPALITY CITY OF HAMPTON,

STREET NAME ROUTE NUMBER *	FROM	TERMINI TO	R/W WIDTH (FEET)	PAVEMENT WIDTH (FEET)	CENTER- LINE MILES	NUMBER OF LANES	LANE MILES	FUNC. CLASS. (TPD USE ONLY)
(1) BENTHALL RD	0.03 M N HUNLAC AVE	CUL-DE-SAC	50	31	0.19	2	0.38	
(2) BOXWOOD ST	SOUTHERLAND DR	0.02 M N STONEHURST DR	50	32	0.02	2	0.04	
(3) FIREFLY LA	SEMPLE FARM RD	CUL-DE-SAC	50	32	0.14	2	0.28	
(4) FRANKLIN ST	LINCOLN ST	PEMBROKE AVE W	60	34	0.14	2	0.28	
(5) SAUNDERS RD	BIG BETHEL RD	WCL	VAR	54	0.73	4	2.92	
(6) WINGFIELD DR	ABERDEEN RD	DEAD END E	50	32	0.02	2	0.04	

*COUNCIL RESOLUTION & MAP ATTACHED

SIGNED  MUNICIPAL OFFICIAL
DATE 12/14/2011

SIGNED _____ RESIDENT ENGINEER
DATE _____

Submit to: _____
Resident Engineer in Triplicate

CLASSIFIED BY _____ TPD ENGINEER
DATE _____



City of Hampton, VA
FY 2018 VDOT Road Submittal
(Additions)

Prepared by: Dept. of Public Works -Engineering Services

Scale: 1" = 200'

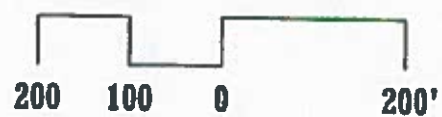

Map printed: 14 November, 2016



City of Hampton, VA
FY 2018 VDOT Road Submittal
(Additions)

Prepared by: Dept. of Public Works -Engineering Services

Scale: 1" = 200'



Map printed: 14 November, 2016



City of Hampton, VA
FY 2018 VDOT Road Submittal
(Additions)

Prepared by: Dept. of Public Works -Engineering Services

Scale: 1" = 300'



Map printed: 14 November, 2016

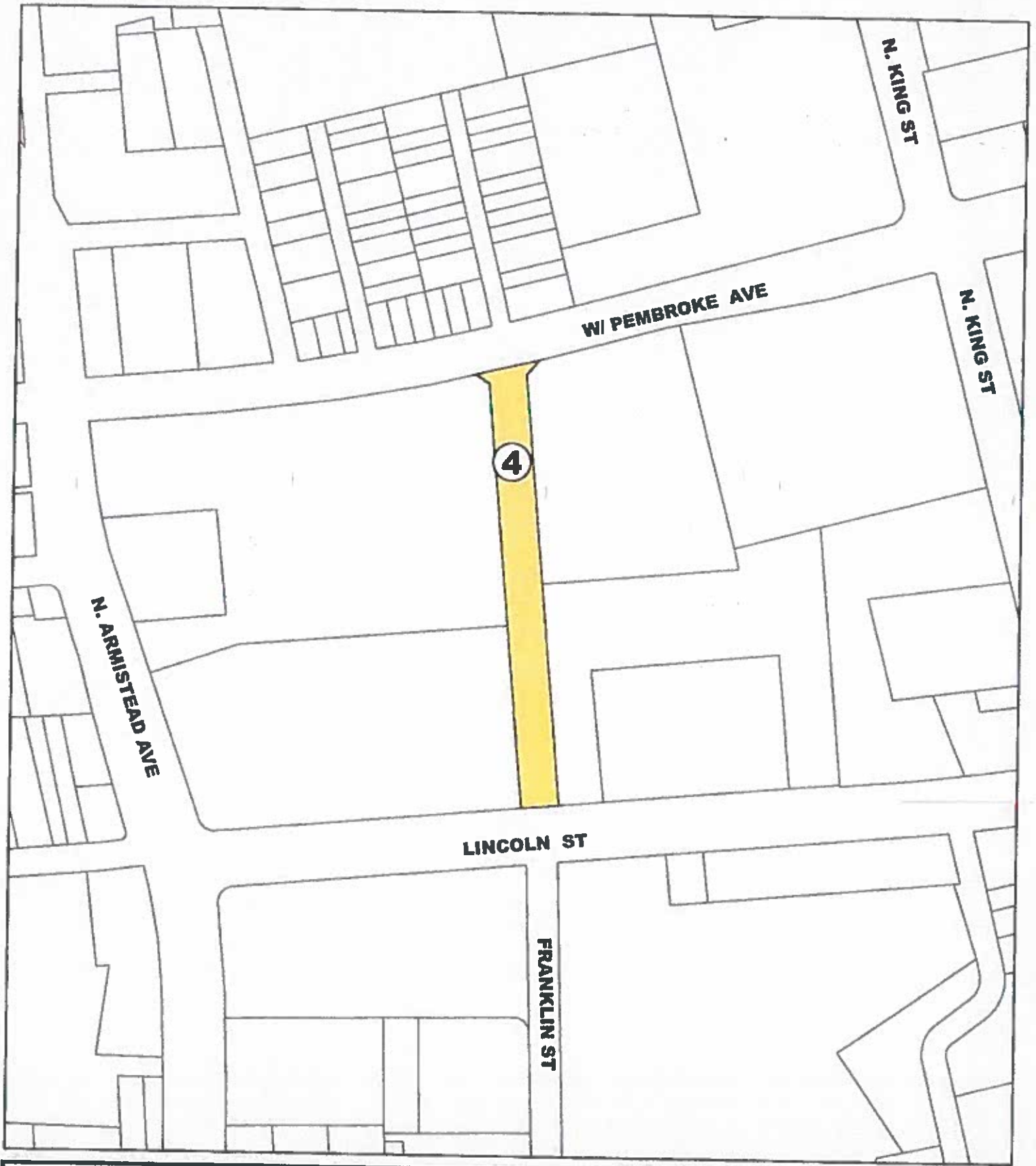

City of Hampton, VA
FY 2018 VDOT Road Submittal
(Additions)

Prepared by: Dept. of Public Works - Engineering Services

Scale: 1" = 200'



Map printed: 14 November, 2016

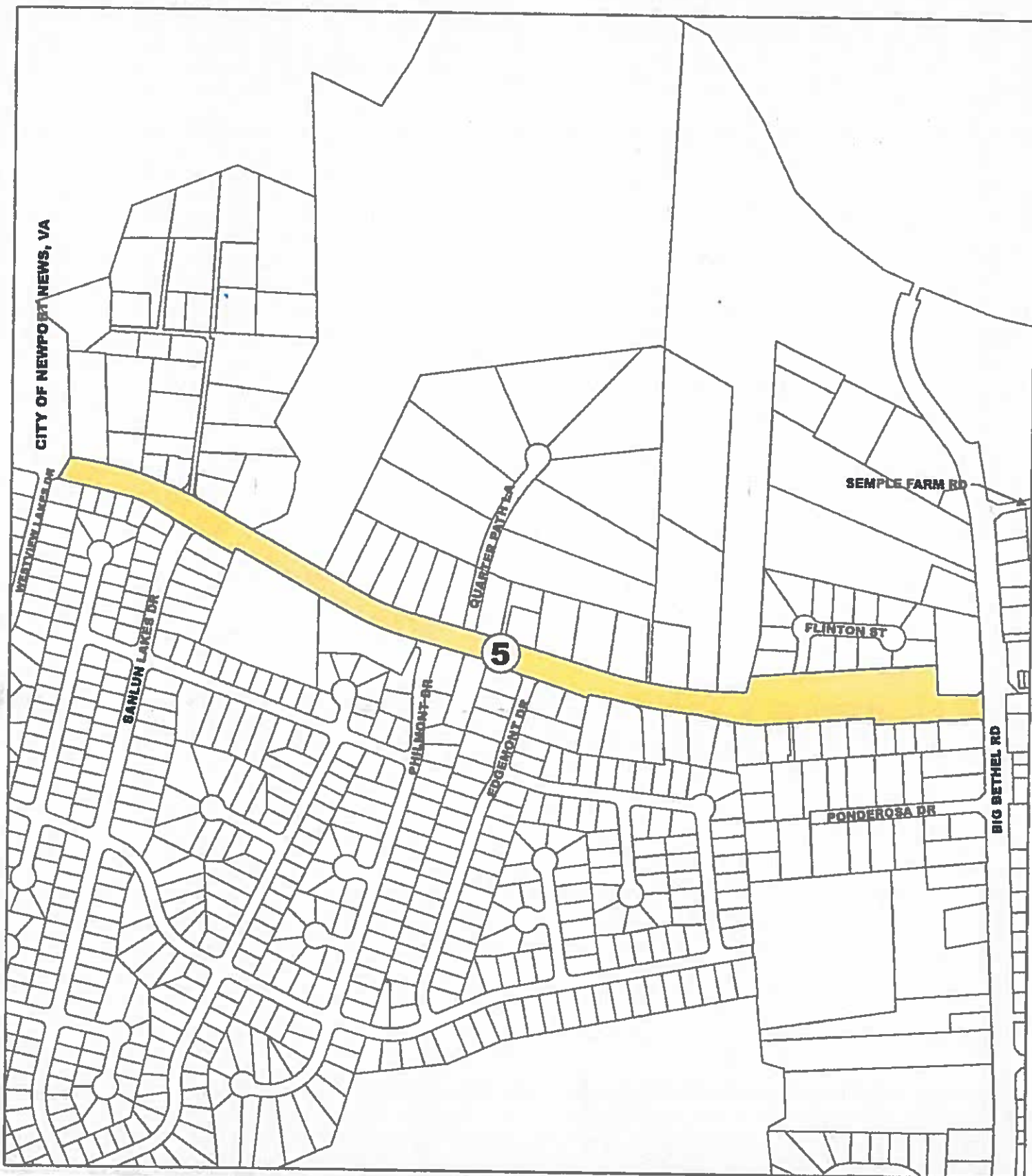

City of Hampton, VA
FY 2018 VDOT Road Submittal
(Additions)

Prepared by: Dept. of Public Works -Engineering Services

Scale: 1" = 500'



Map printed: 14 November, 2016



City of Hampton, VA
FY 2018 VDOT Road Submittal
(Additions)

Prepared by: Dept. of Public Works -Engineering Services

Scale: 1" = 200'



Map printed: 14 November, 2016

1.97 Centerline Miles
3.94 Lane Miles
(Deletions)

REQUEST FOR STREET ADDITIONS OR
DELETIONS FOR MUNICIPAL ASSISTANCE
PAYMENTS Section 33.1-4 1.1
Code of Virginia

MUNICIPALITY Hampton (FMA Transfer to National Park Service)

STREET NAME ROUTE NUMBER *	FROM	TERMINI TO	RW WIDTH (FEET)	PAVEMENT WIDTH (FEET)	CENTER- LINE MILES	NUMBER OF LANES	LANE MILES	FUNC. CLASS. (TPD USE ONLY)
(1) BATTERY DERUSSEY	FENWICK RD	FENWICK RD	N/A	20	0.16	2	0.32	
(2) FENWICK RD	0.10 M N STILLMAN DR	BATTERY DERUSSEY	N/A	26	0.02	2	0.04	
(3) FENWICK RD	BATTERY DERUSSEY	ROSE CIR (S)	N/A	25	0.38	2	0.76	
(4) FENWICK RD	ROSE CIR (S)	FULLER LA	N/A	22	0.18	2	0.36	
(5) FENWICK RD	FULLER LA	0.18 M N	N/A	20	0.18	2	0.36	
(6) FULLER LA	FENWICK RD	0.09 M N	N/A	16	0.09	2	0.18	
(7) GULICK DR	ROSE CIR (S)	0.49 M S	N/A	25	0.49	2	0.98	
(8) GULICK DR	0.17 M S GULICK DR CONNECTOR	0.22 M N	N/A	25	0.22	2	0.44	
(9) GULICK DR CONNECTOR	GULICK DR	FENWICK RD	N/A	20	0.08	2	0.16	
(10) ROSE CIR (N)	FENWICK RD	0.08 M E	N/A	24	0.08	2	0.16	
(11) ROSE CIR (S)	FENWICK RD	GULICK DR	N/A	17	0.09	2	0.18	

*COUNCIL RESOLUTION & MAP ATTACHED

SIGNED  MUNICIPAL OFFICIAL
12/12/2016 / DATE

SIGNED _____ RESIDENT ENGINEER _____ DATE _____

Submit to: _____
Resident Engineer in Triplicate

CLASSIFIED BY _____ TPD ENGINEER _____ DATE _____

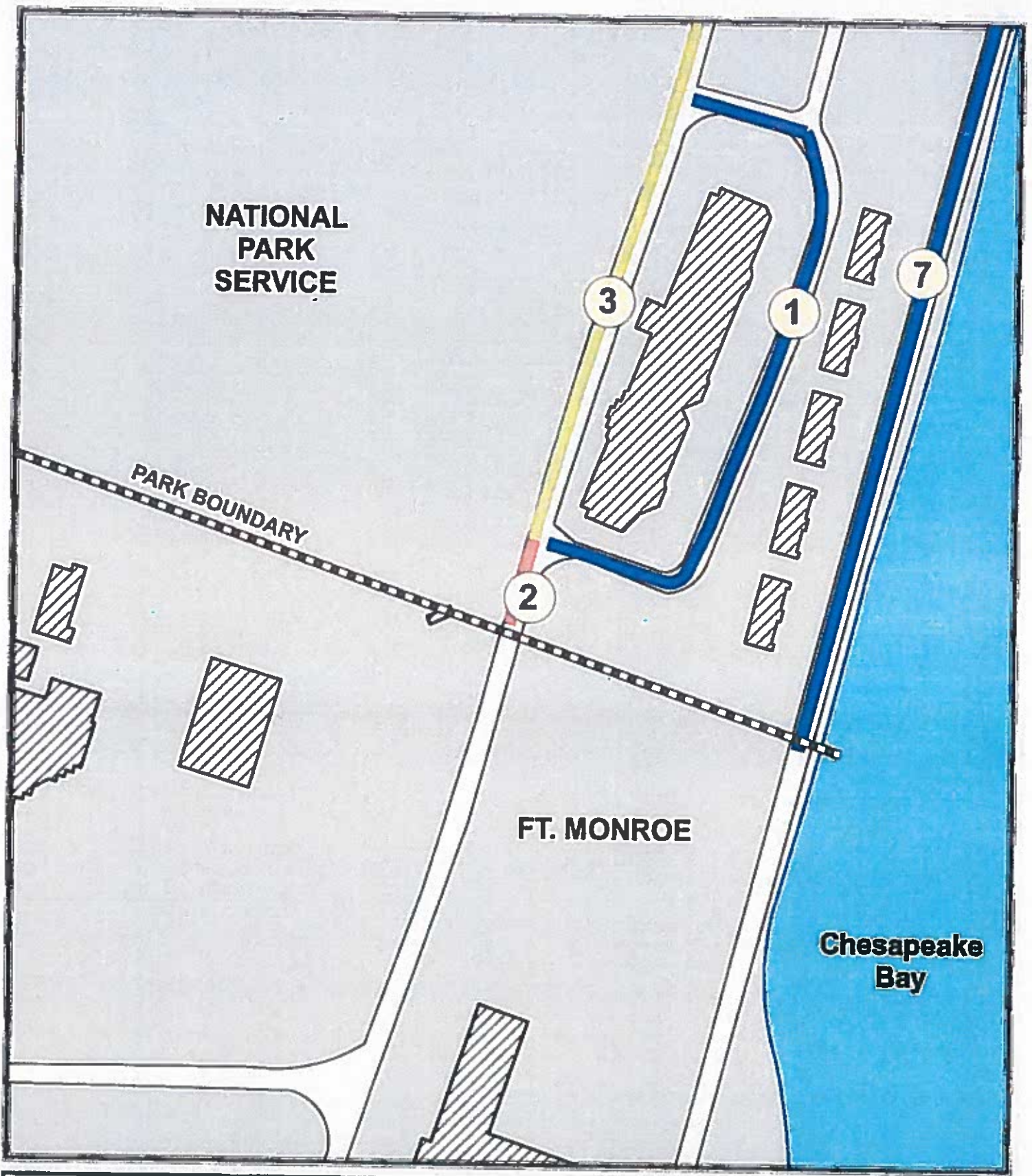

City of Hampton, Va.
FY 2018 VDOT Road Submittal
(Deletions)
 Prepared by: Dept. of Public Works -Engineering Services

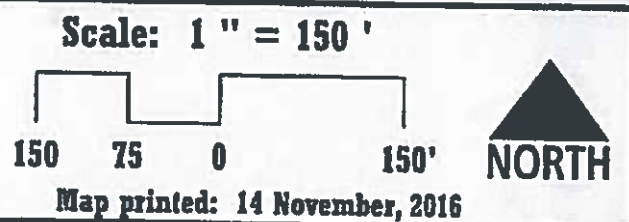

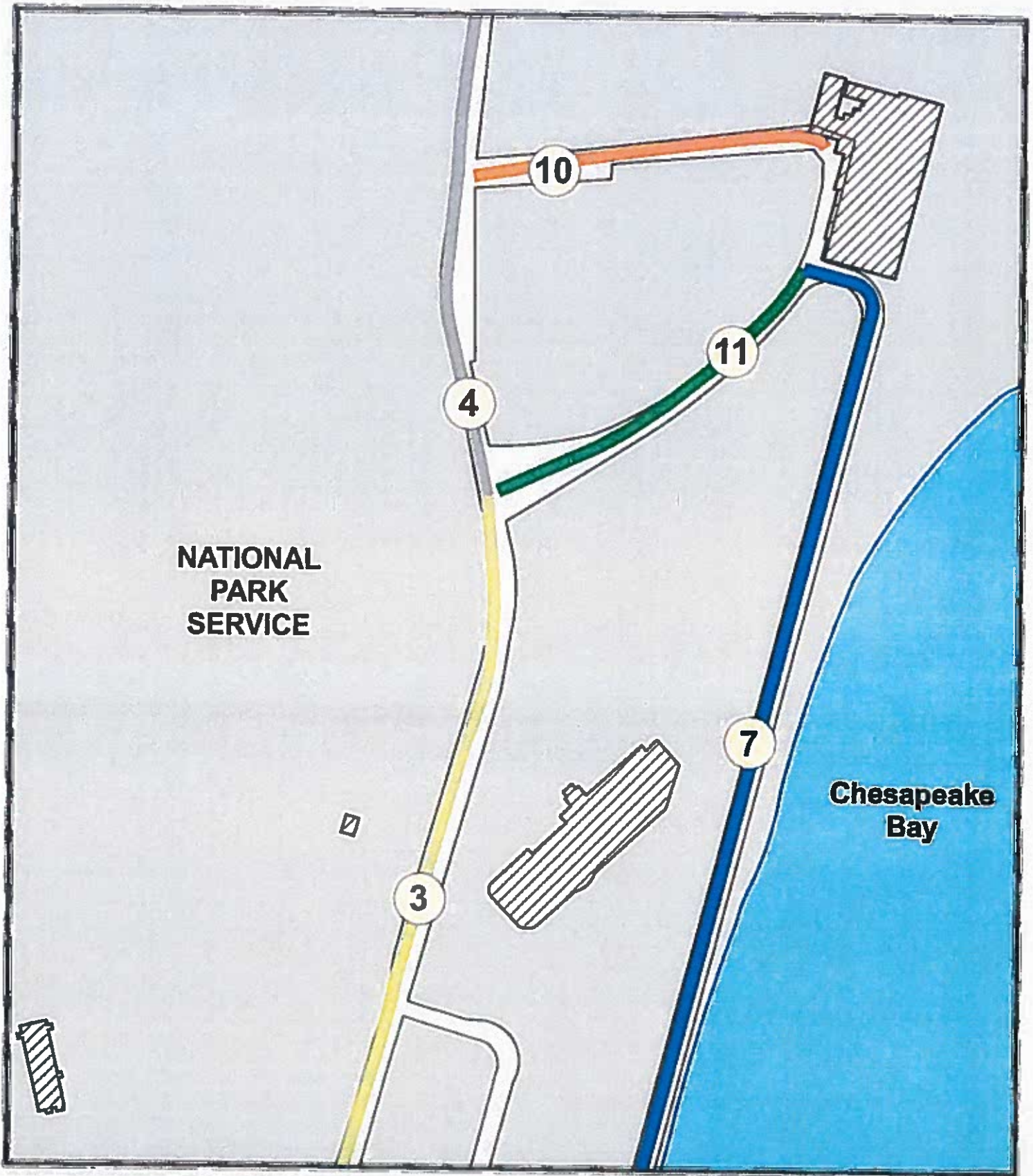

**City of Hampton, Va.
 FY 2018 VDOT Road Submittal
 (Deletions)**

Prepared by: Dept. of Public Works -Engineering Services

Scale: 1" = 150'



Map printed: 14 November, 2016

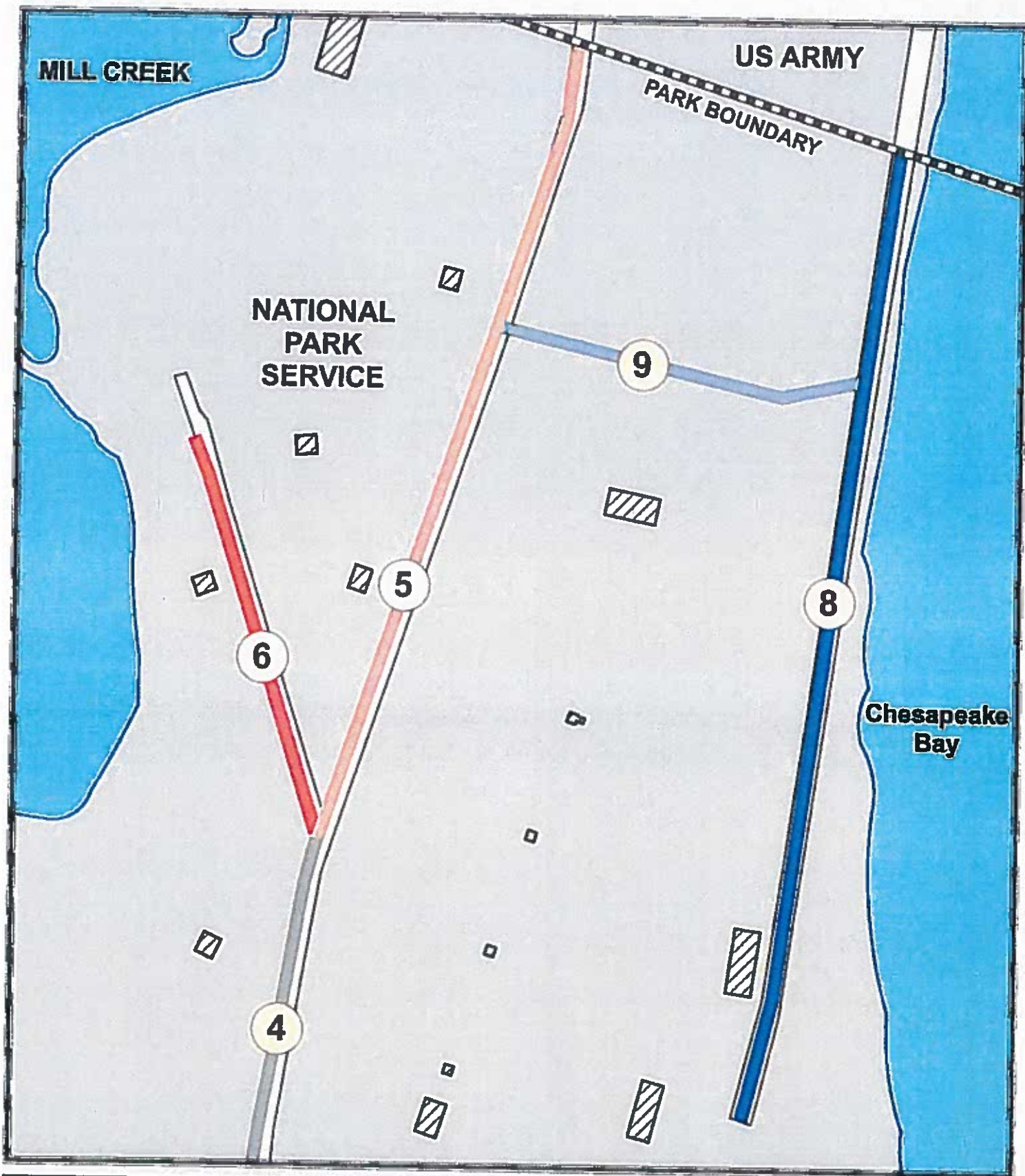

City of Hampton, Va.
FY 2018 VDOT Road Submittal
(Deletions)
 Prepared by: Dept. of Public Works -Engineering Services

