

HAMPTON VA

**Item
22-0138**

***2201 Mingee Drive
Atlantic Machinery, Inc.***

**City Council
April 13, 2022**

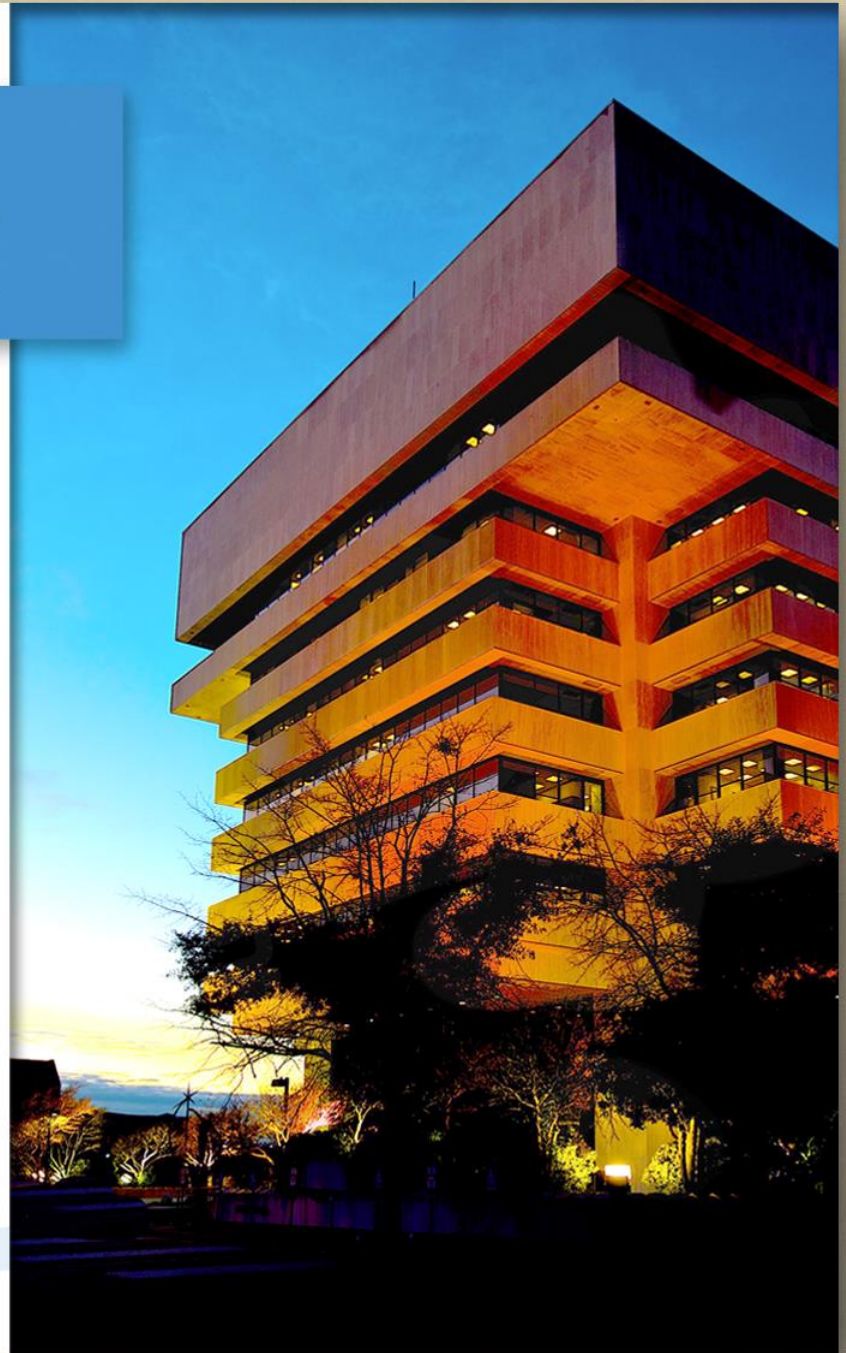

Application

Use Permit for Vehicle Repair,
Heavy



Site Location



Proposal



- Assembly & service of specific commercial vehicles
- Street sweepers & jet/vacuum equipment
- 1-2 equipment rentals

Aerial View



Site Elevation



Site Elevation



Background

- 10/2020 ZOA changes to service, repair, & storage of vehicles
- Use permit required for heavy vehicle repair
- 1st Use Permit of its kind

Zoning

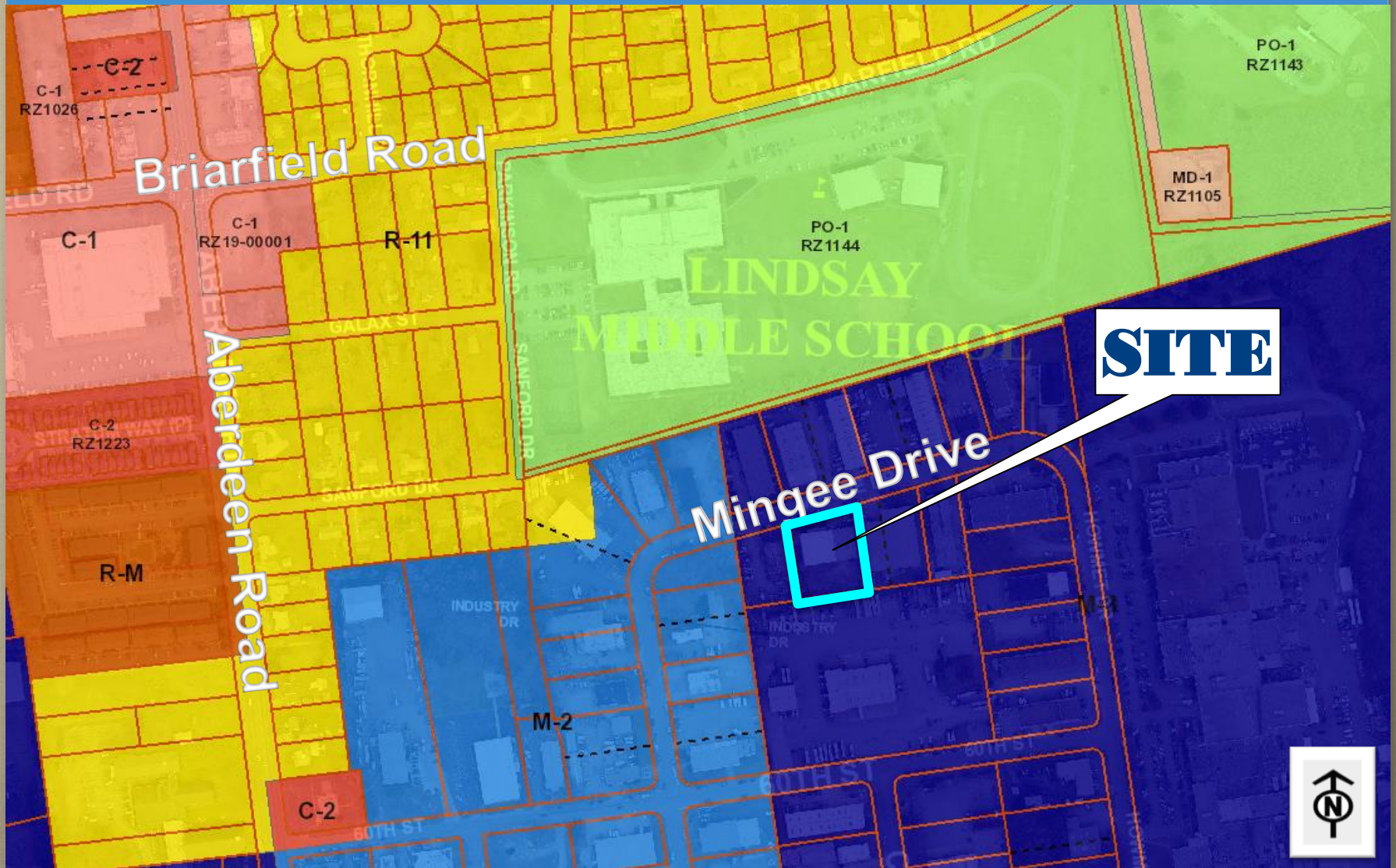

Future Land Use Plan

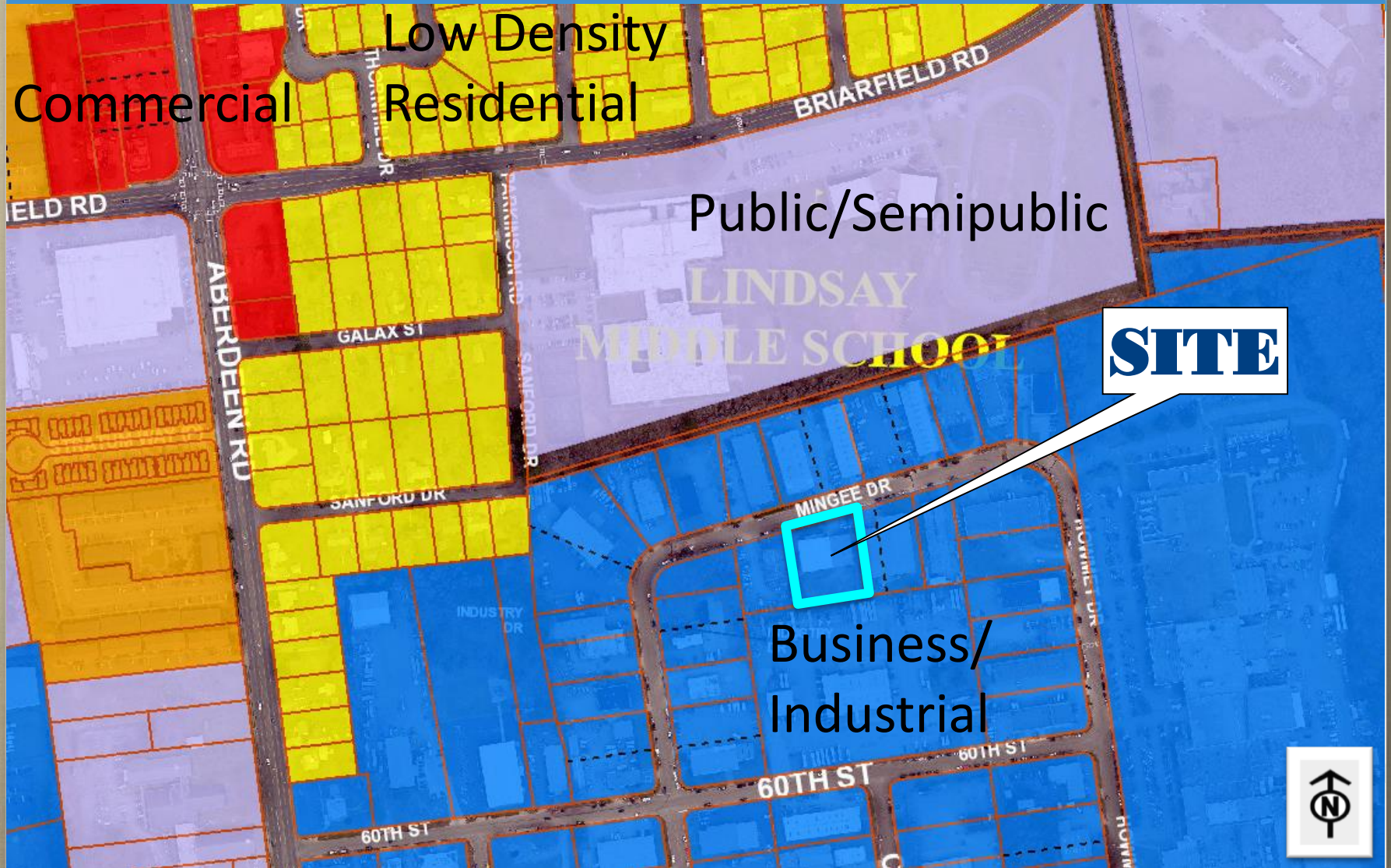

Public Policy

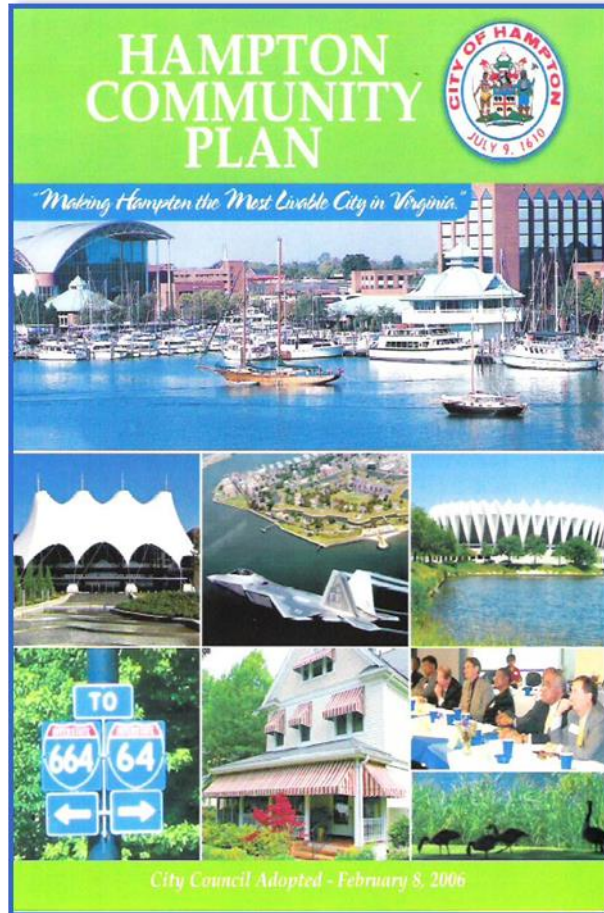

Evaluate land use proposals from a regional, city-wide, and neighborhood perspective

Nurture small & start-up businesses

Strengthen the ability of older commercial and industrial areas to support new and expanded business activity

Staff Analysis

COPELAND INDUSTRIAL PARK

Design Guidelines
June 20, 2017



- M-3 Zoning District
- Copeland Industrial Park
- Copeland Design Guidelines

HAMPTON VA

ECONOMIC DEVELOPMENT AUTHORITY
OF THE CITY OF HAMPTON, VIRGINIA

Recommended Conditions

- Use Standards
- Exterior Storage Areas
 - Screening
 - Fencing
- Accessory Structures
- Parking
- Landscaping
- Compliance with applicable laws

Recommendation

Planning Commission & Staff
recommend
approval #22-0138
with 7 conditions