

ENCROACHMENT APPLICATION 2023-006

LUMOS NETWORKS, INC. d/b/a SEGRA
South side of Autozone Way



Hampton
VIRGINIA

Council Briefing

June 14, 2023

Aerial View of South side of Autozone Way



June 14, 2023

Council Briefing
Slide 2

Typical View of Proposed Encroachment Area on south side of Autozone Way



June 14, 2023

Council Briefing
Slide 3

Exhibit Showing Proposed Encroachment Area

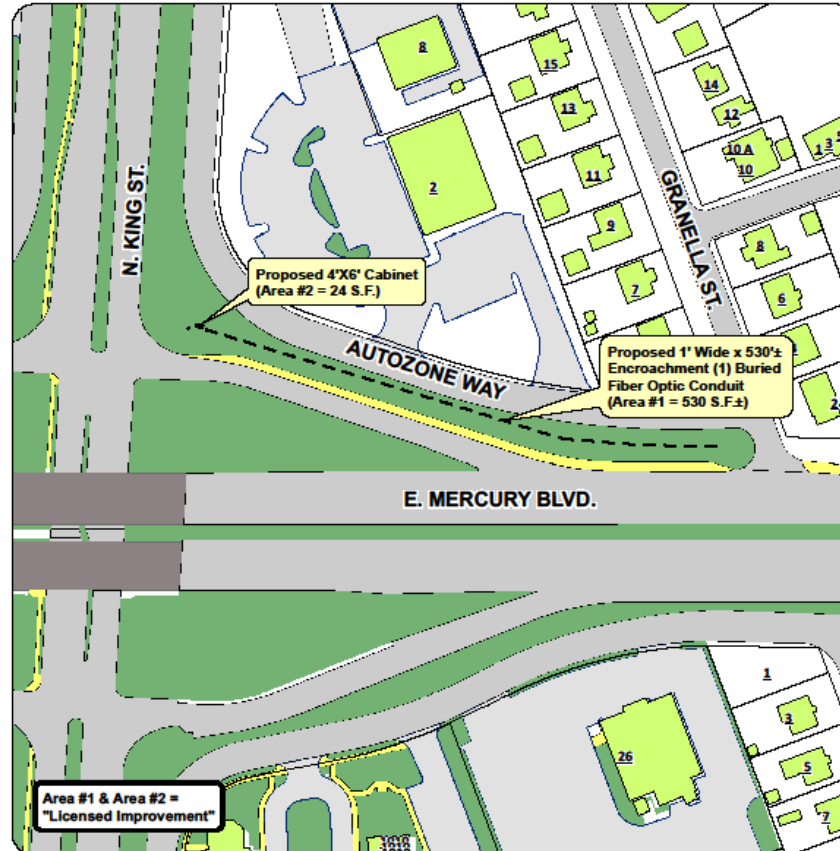

Exhibit 'A'
Encroachment Granted to:
Lumos Networks Inc., d.b.a., SEGRA
at Autozone Way

Scale: 1" = 100'



HAMPTON VA

Prepared by: CITY of HAMPTON Dept. of Public Works - Engineering Services

Map printed: 2 May, 2023

DISCLAIMER Although the information contained herein is believed to be reliable, no warranty, expressed or implied, is made regarding the accuracy, completeness, legality, reliability, or usefulness of any information, either isolated or in the aggregate, unless expressly specified. Neither is this information intended as a substitute for applicants' obligation to retain its own independent professional advice from an engineer, surveyor, attorney, or the like.

June 14, 2023

Council Briefing
Slide 4

Proposed Equipment Plan

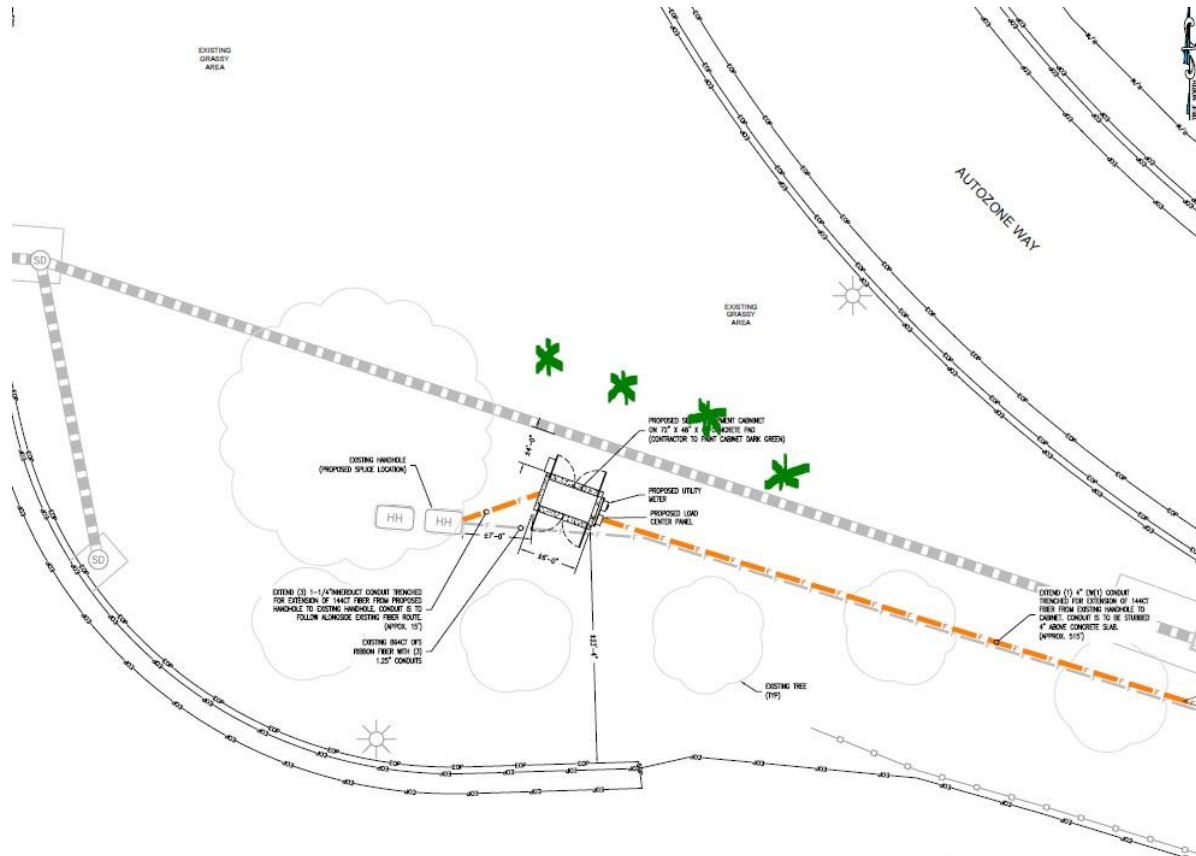

E MERCURY BLVD
(ROUTE 258)
(VARIABLE WIDTH R.O.W.)

NOTE
1. THE EXISTING UTILITY INFORMATION SHOWN REPRESENTS THE BEST DATA AVAILABLE FROM EXISTING DOCUMENTATION AND FIELD EXPERIENCE. ALL LOCATIONS SHOWN SHOULD BE CONSIDERED APPROXIMATE AND A FIELD INVESTIGATION MUST BE PERFORMED IN THE VICINITY OF ANY CONSTRUCTION ACTIVITIES. NOTE THAT THESE PLANS MAY NOT SHOW ALL UTILITIES THAT ARE PRESENT AT THE SITE.
2. THE CROWN DOES NOT REPRESENT A BOUNDARY SURFACE. THE RIGHT-OF-WAY, PROPERTY LINE AND/OR EASEMENTS SHOWN HEREON REPRESENT INFORMATION OBTAINED FROM PUBLIC RECORDS.
3. SEE GENERAL NOTES (SHEET 2) FOR FURTHER CONSTRUCTION REQUIREMENTS AND INFORMATION.
UNPROTECTED CONDUITS TO BE PLACED MIN. 6" BELOW GRADE TO AVOID STORM DRAIN

- PROPOSED CABINET LOCATION:
LATITUDE: 37.044057°
LONGITUDE: -76.347751°
- EXTEND (1) 4" EW(1) CONDUIT TRENCHED FOR EXTENSION OF 144CT FIBER FROM EXISTING HANDHOLE TO CABINET. CONDUIT IS TO BE STUBBED 4" ABOVE CONCRETE SLAB. (APPROX. 15')
- EXTEND (1) 4" EW(1) CONDUIT TRENCHED FOR EXTENSION OF 144CT FIBER FROM EXISTING HANDHOLE TO CABINET. CONDUIT IS TO BE STUBBED 4" ABOVE CONCRETE SLAB. (APPROX. 515')

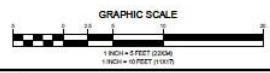

PROFESSIONAL
STAMP

SEGRA™

SITE INFORMATION
SEGRA ENGINEER: ALLISON UNDERDAU
ENGINEERING FIRM: ISH-C ENGINEERING SERVICES, LLC
SEGRA PROJECT NUMBER: 07098-008
SERVICE NUMBER: S04 2770000
LOCATION: SW CORNER OF GRANIELLA STREET AND AUTOZONE WAY

DESIGN RECORD

REVISIONS				
REV	DATE	ENG	CAD	COMMENT
C	03/07/23	TTS	LAT	CABINET LOCATION
B	11/09/22	TTS	LAT	ROUTE UPDATE
A	09/22/22	TTS	LAT	PRELIMINARY

SHEET TITLE
EQUIPMENT PLAN

SHEET NUMBER
SHEET 4 OF 11



Recommendation

City staff recommends approval of this encroachment application 2023-006 to allow Segra to install buried fiber conduit and an equipment cabinet on the south side of Autozone Way as shown on the preceding slides. Segra agreed to paint the cabinet dark green and will install landscaping toward improved aesthetics.

QUESTIONS?



June 14, 2023

Council Briefing
Slide 7