

SURVEY NOTES

1. TOPOGRAPHIC INFORMATION WAS TAKEN FROM A TOPOGRAPHIC SURVEY PERFORMED BY MIDGETTE AND ASSOCIATES, CHESAPEAKE, VIRGINIA ON 7/19/06. METES AND BOUNDS WERE COMPILED FROM PLATS AND/OR DEEDS OF RECORD. NO BOUNDARY SURVEY WAS PERFORMED BY MIDGETTE AND ASSOCIATES.
2. THIS SURVEY WAS PREPARED WITHOUT THE BENEFIT OF A TITLE SEARCH/REPORT AND MAY NOT SHOW ANY/ALL EASEMENTS AND RESTRICTIONS OF RECORD THAT MAY EFFECT THE SUBJECT PROPERTY.
3. PROPERTY IS SUBJECT TO ALL EASEMENTS AND RESTRICTIONS OF RECORD.
4. FLOOD ZONE DETERMINATION IS BASED ON THE FLOOD INSURANCE RATE MAPS AND DOES NOT IMPLY THAT THE PROPERTY WILL OR WILL NOT BE FREE FROM FLOODING OR DAMAGE.
5. THIS SITE APPEARS TO BE LOCATED IN THE F.I.R.M. ZONE "C" AS SHOWN ON COMMUNITY PANEL NUMBER 515527 0014F EFFECTIVE DATE 7/03/95.
6. NO SUBSURFACE INVESTIGATION WAS PERFORMED BY MIDGETTE AND ASSOCIATES.
7. MERIDIAN SOURCE FOR THIS SURVEY IS BASED UPON STATE GRID (SOUTH ZONE). MAGNETIC DECLINATION IS COMPUTED AND NOT OBSERVED.
8. NO WETLAND AREAS HAVE BEEN DELINEATED.
9. ALL PHYSICAL EVIDENCE OF UTILITIES SHOWN ON THIS SURVEY IS FROM SURFACE EVIDENCE.
10. THE TEMPORARY BENCHMARK IS PIN SET W/CAP. ELEVATION = 9.86.
11. BASED ON THIS SURVEY, THE PROPOSED TOWER HAS BEEN CERTIFIED BY MIDGETTE AND ASSOCIATES. THAT THE COORDINATE LOCATION OF THE REFERENCED TOWER AT THE REFERENCED SITE IS ACCURATE WITHIN 50'± HORIZONTALLY AND THE ELEVATION IS ACCURATE WITHIN 20'± VERTICALLY. THE HORIZONTAL DATUM (COORDINATES) ARE IN TERMS OF THE NORTH AMERICAN DATUM OF 1983 (NAD 83) AND ARE EXPRESSED AS DEGREES, MINUTES, AND SECONDS. THE VERTICAL DATUM (ELEVATIONS) ARE IN TERMS AS DEFINED BELOW AND ARE DETERMINED TO THE NEAREST TENTH OF A FOOT.

EXISTING MONOPOLE
NAD 1983
LATITUDE: 37° 02' 27.33" N
LONGITUDE: 76° 18' 30.86" W
NAVD 88 ELEVATION: 12.5

CONSTRUCTION NOTES

- 1 NEW VERIZON WIRELESS 12' X 30' EQUIPMENT SHELTER. SEE DETAIL 1, SHEET A-1.
- 2 NEW VERIZON WIRELESS 12' X 30' LEASE AREA.
- 3 NEW VERIZON WIRELESS FENCED COMPOUND EXTENSION (MATCH EXISTING). SEE DETAIL 1 SHEET C-4.
- 4 NEW 12' GRAVEL ACCESS ROAD EXTENSION (TIE INTO EXISTING).

BUILDING SETBACKS - CHAPTER 12, SEC 12-4

	REQUIRED	PROPOSED (FROM LEASE AREA)
FRONT SETBACK	N/A'	N/A
SIDE SETBACK	10'	33.19'
SIDE SETBACK	10'	43.08'
REAR SETBACK	15'	20.88'

CLARK NEXSEN

Architecture & Engineering

6160 KEMPSVILLE CIRCLE
NORFOLK, VIRGINIA 23502
757-455-5800 FAX 757-455-5638
WWW.CLARKNEXSEN.COM

verizon wireless

1831 RADY COURT
RICHMOND, VA 23222

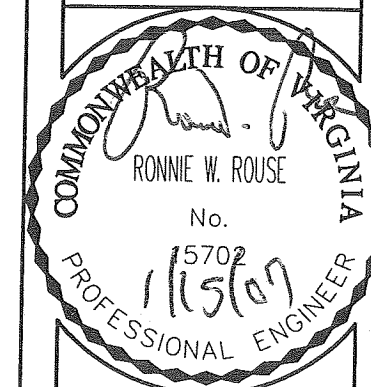

SITE INFO:

**BUCKROE
BEACH
COLOCATE
MONOPOLE**

24 SKYLAND DRIVE
HAMPTON, VA
23663

DESIGN: AZ
DRAWN: MAA
REVIEW: RWR
TTY DATE: 6/28/06
COMM. NO. 1887.2 (WWW)

SUBMITTALS

SYM.	DESCRIPTION	DATE
△	SITE PLAN DRAWINGS	7/28/06
△	FINAL SITE PLAN DRAWINGS	1/15/07
△		
△		
△		
△		
△		

SHEET NAME:

**SURVEY AND
SITE PLAN**

SHEET NO.:

C-1

1 SURVEY AND SITE PLAN

FOR 24" X 36" PLOT - 1" = 20'
FOR 11" X 17" PLOT - 1" = 40'

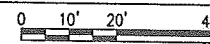

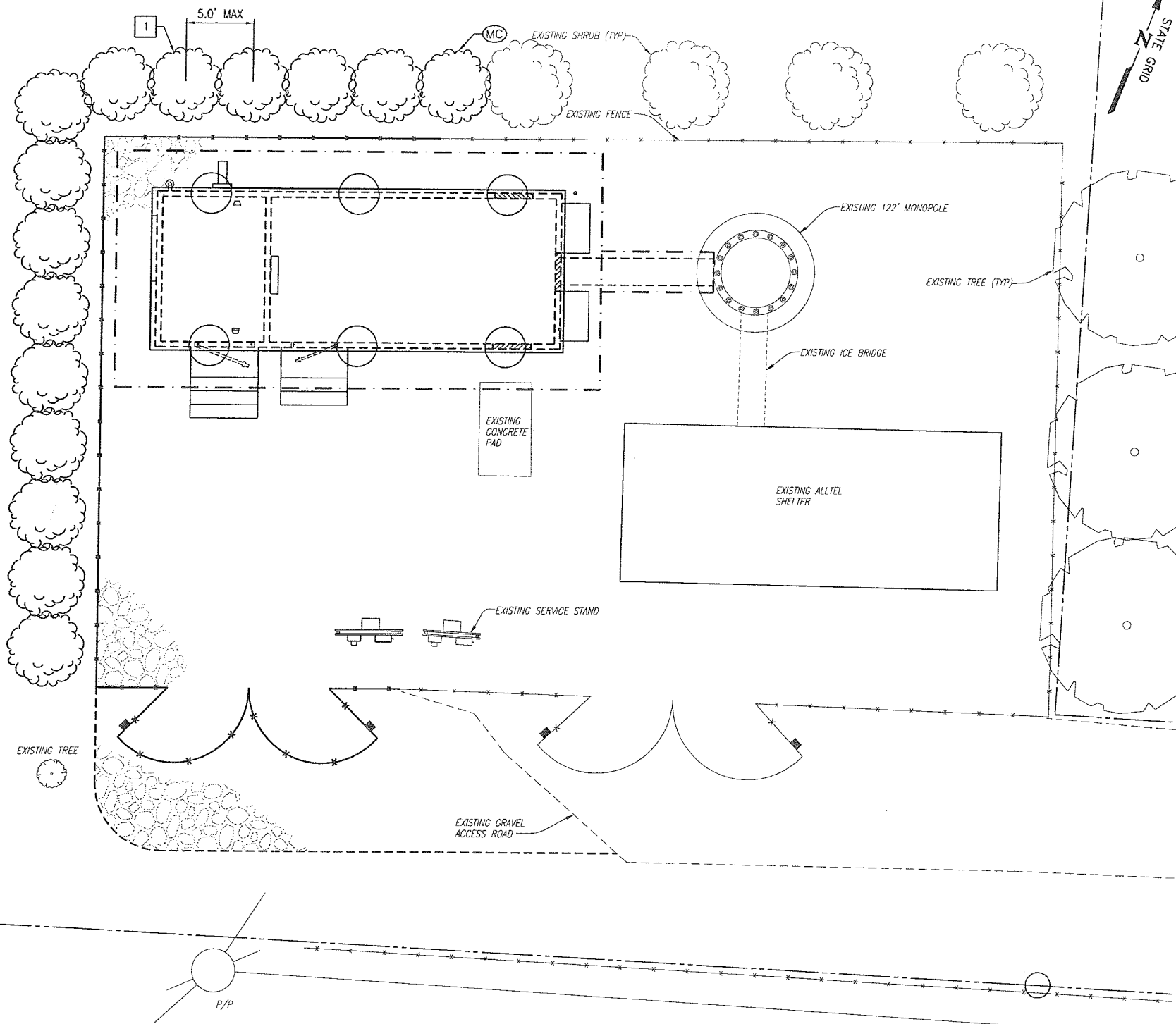

1
L-1

LANDSCAPING PLAN

PLANTING SCHEDULE							
TYPE	BOTANICAL NAME	COMMON NAME				QUANTITY	REMARKS
			CALIPER	HEIGHT	SPREAD		
SHRUBS							
MC	MYRICA CERIFERA	SOUTHERN WAX MYRTLE	-	2'-3'	24"-36"	15	

GENERAL NOTES:

1. THE CONTRACTOR SHALL VERIFY THAT TOTAL QUANTITIES INDICATED IN THE PLANT LIST OR SCHEDULE AGREES WITH QUANTITIES SHOWN ON PLANTING LAYOUT. IF DISCREPANCIES, USE TOTAL OF QUANTITIES SHOWN ON PLANTING LAYOUT.
2. THE CONTRACTOR SHALL PROVIDE THE QUANTITIES REQUIRED TO COMPLETE PROPOSED PLANTING AS SHOWN ON THE LANDSCAPE PLAN.
3. CONTRACTOR SHALL ENSURE POSITIVE DRAINAGE.
4. ALL BEDS SHALL BE CLEAN AND WEEDED.
5. ALL AREAS NOT PAVED OR PLANTED SHALL BE SEEDED.
6. PROVIDE ALL NECESSARY PLANT MATERIALS, LABOR, TOOLS, AND MATERIALS TO COMPLETE THIS PROJECT IN A WORKMANLIKE, PROFESSIONAL MANNER.
7. ALL TREES, SHRUBS, AND GROUND COVERS SHALL BE SPECIMEN QUALITY (AMERICAN ASSOCIATION OF NURSERYMEN STANDARDS), SHALL BE NURSERY-GROWN, AND IN A HEALTHY, INSECT AND DISEASE-FREE, CONDITION.
8. NO SUBSTITUTIONS OF SIZE OR VARIETY OF PLANT MATERIAL WITHOUT PRIOR APPROVAL OF LANDSCAPE DESIGNER.
9. STAKE TREES ACCORDING TO A.A.N. (AMERICAN ASSOCIATION OF NURSERYMEN) STANDARDS.
10. "B&B" INDICATES BALLED AND BURLAPPED.
11. "CON" INDICATES CONTAINERIZED PLANTS.
12. ALL TREES AND SHRUBS HAVE BEEN LOCATED WITH RESPECT TO PROPOSED OR EXISTING UTILITIES AS ACCURATELY AS POSSIBLE. FIELD VERIFY LOCATIONS FOR ALL UTILITIES PRIOR TO INSTALLING PLANT MATERIAL.
13. VERIFY ALL DIMENSIONS IN THE FIELD, NOTIFY OWNER AND LANDSCAPE DESIGNER OF ANY VARIANCE FROM PLANS.
14. PROVIDE OWNER FULL 12 MONTHS MATERIAL AND LABOR GUARANTEE ON ALL PLANT MATERIAL.
15. THOROUGHLY WATER ALL PLANT MATERIAL AFTER PLANTING AND MULCHING. APPLY SLOW RELEASE FERTILIZER TO ALL PLANTS PER MANUFACTURER'S DIRECTIONS ON LABEL AT PLANTING. IN ADDITION TO NORMAL FEEDING, USE A SOLUTION CONDUCIVE TO TRANSPLANTING ON PLANTS THAT ARE RELOCATED ALSO PER MANUFACTURER'S DIRECTIONS ON LABEL.
16. PROVIDE 12" MIN DEPTH OF TOPSOIL AND SOIL MIXTURE @ ALL SHRUB BED LOCATIONS. PROVIDE 2" MIN DEPTH OF TOPSOIL AND SOIL MIXTURE @ ALL DISTURBED GRASS AREAS.
17. PRUNE ALL PLANT MATERIAL - REMOVE RANK AND DEAD GROWTH ONLY. PRUNE FOR NATURAL SHAPE PER SPECIES.
18. MULCH TO BE 2" MIN DEPTH SHREDDED HARDWOOD BARK MULCH IN ALL BED AREAS.
19. ANY QUESTIONS REGARDING THE INSTALLATION OF THIS PROJECT SHOULD BE BROUGHT TO THE ATTENTION OF LANDSCAPE DESIGNER @ 757-455-5800.
20. IN PLANTING BEDS, OMIT THE COMPACTED EARTH SAUCER AND COVER THE BEDS WITH MULCH (2" MIN DEPTH). AT HEDGE ROWS PROVIDE MULCH IN A CONTINUOUS BED. ALL GROUPINGS OF SHRUBS SHALL BE INSTALLED IN CONTINUOUS MULCH BEDS.
21. WHERE PLANTING BEDS ABUT WALK AND CURBS, DEPRESS TOPS OF MULCHED BEDS 3/4".
22. TREE AND SHRUB PITS SHALL BE 3 TIMES SIZE OF ROOT BALL AND BACK FILLED WITH FOLLOWING SOIL MIXTURE THOROUGHLY MIXED: 2 PARTS JAMES RIVER SAND, 2 PARTS COMPOSTED HORSE MANURE OR CATTLE MANURE, OR ORGANIC COMPOST, AND 6 PARTS GOOD QUALITY TOPSOIL.
23. AT CONTINUOUS BEDS OF SHRUBS, PERENNIALS AND GROUND COVER AREAS EXCAVATE SUBSOIL TO 12" MIN DEPTH AND BACK FILL WITH SOIL MIXTURE AS LISTED ABOVE.
24. TEST SOIL BEFORE PLANTING AND ADD PROPER SOIL AMENDMENTS TO SOIL TO ESTABLISH pH OF 6.5.
25. PREPARE SOIL WITH HI CALCIUM LIME @ RATE SHOWN ON SEEDING SCHEDULE, SHEET L-2.

CONSTRUCTION NOTES

- 1 SHRUB, TYP. SEE PLANT SCHEDULE THIS SHEET. SEE DETAIL 1, SHEET L-2.

LANDSCAPE PLAN PREPARED BY:

Martin Arredondo

MARTIN ARREDONDO
VIRGINIA CERTIFIED HORTICULTURIST #1967

CLARK•NEXSEN
Architecture & Engineering

6160 KEMPSVILLE CIRCLE
NORFOLK, VIRGINIA 23502
757-455-5800 FAX 757-455-5638
WWW.CLARKNEXSEN.COM

verizon wireless

1831 RADY COURT
RICHMOND, VA 23222

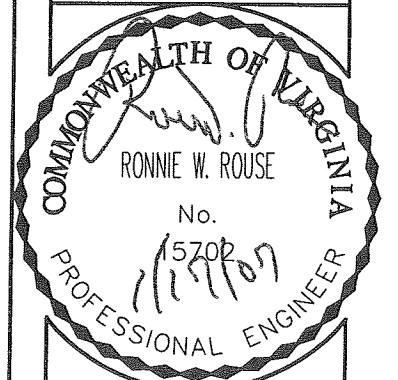

SITE INFO:

**BUCKROE
BEACH
COLOCATE
MONOPOLE**

24 SKYLAND DRIVE
HAMPTON, VA
23663

DESIGN: MAA
DRAWN: MAA
REVIEW: RWR
TTV DATE: 6/28/06
COMM. NO. 1887.2 (WWW)

SUBMITTALS

SYM.	DESCRIPTION	DATE
△	SITE PLAN DRAWINGS	7/28/06
△	FINAL SITE PLAN DRAWINGS	1/15/07
△		
△		
△		
△		
△		

SHEET NAME:

**LANDSCAPING
PLAN**

SHEET NO:

L-1