

RTY DITCH CROSS SECTION
DETAIL FROM THROD SITE PLANS

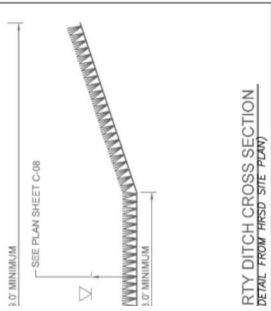

GENERAL NOTES

- THIS EXHIBIT WAS PREPARED BASED ON COMPILED SURVEY FIELDWORK GATHERED BETWEEN NOVEMBER 2014 TO FEBRUARY 2019.

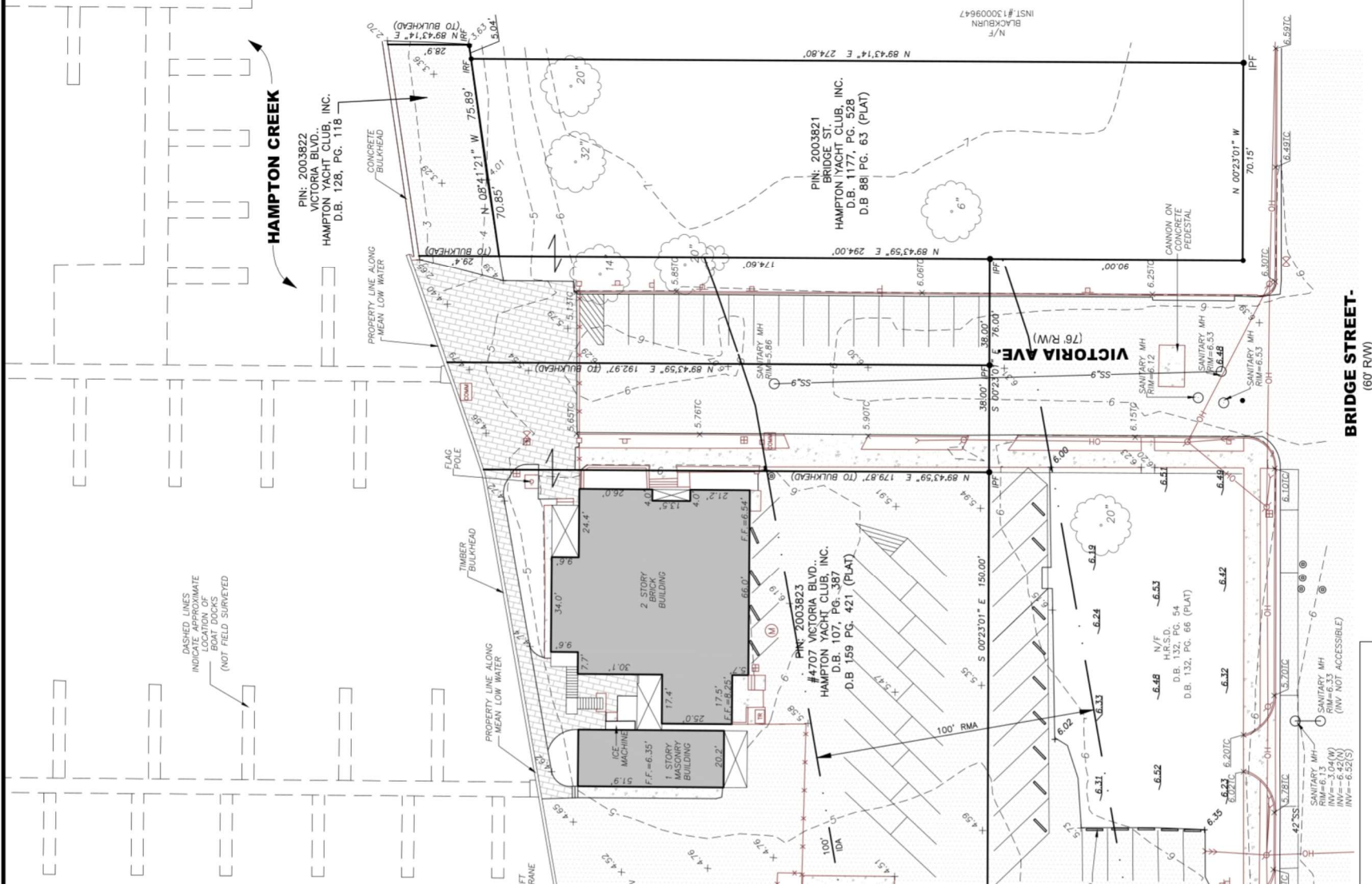
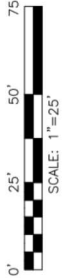

DASHED LINES
INDICATE APPROXIMATE
LOCATION OF
PROPERTY LINE
(NOT FIELD SURVEYED)

HAMPTON CREEK

PIN: 2003822
VICTORIA BLVD.
HAMPTON YACHT CLUB, INC.
D.B. 128, PG. 118

PIN: 2003823
44707 VICTORIA BLVD.
HAMPTON YACHT CLUB, INC.
D.B. 107, PG. 387
D.B. 159 PG. 421 (PLAT)

PIN: 2003821
BRIDGE ST
HAMPTON YACHT CLUB, INC.
D.B. 1177, PG. 528
D.B. 88 PG. 63 (PLAT)

AS-BUILT SURVEY EXHIBIT HAMPTON YACHT CLUB

CITY OF HAMPTON

VIRGINIA

NO.	DATE	REVISION / COMMENT / NOTE



LRI
LANDTECH
RESOURCES, INC.
 ENGINEERING, SURVEYING, GPS

3925 Midlands Road, Williamsburg, VA 23188
 Ph: (757) 565-1677 Fax: (757) 565-0782
 web: landtechresources.com

SCALE: 1"=25'

DATE: 02/11/2019

JOB: 14-267

DRAWN BY: LRI

SHEET: 1 OF 1